

# 5 - SERIES STOP & CROSSING ARMS

**1st Design**  
Switches  
Below  
Motor

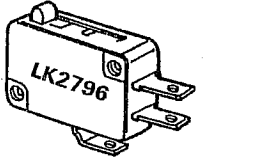

**2nd Design**  
Switches  
Above  
Motor

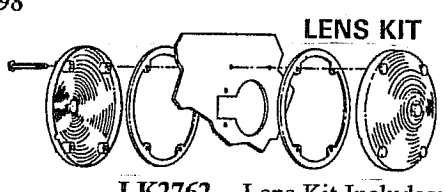
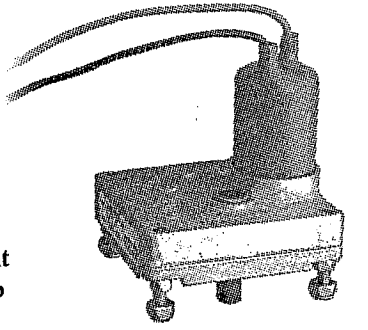
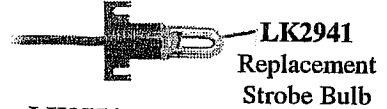
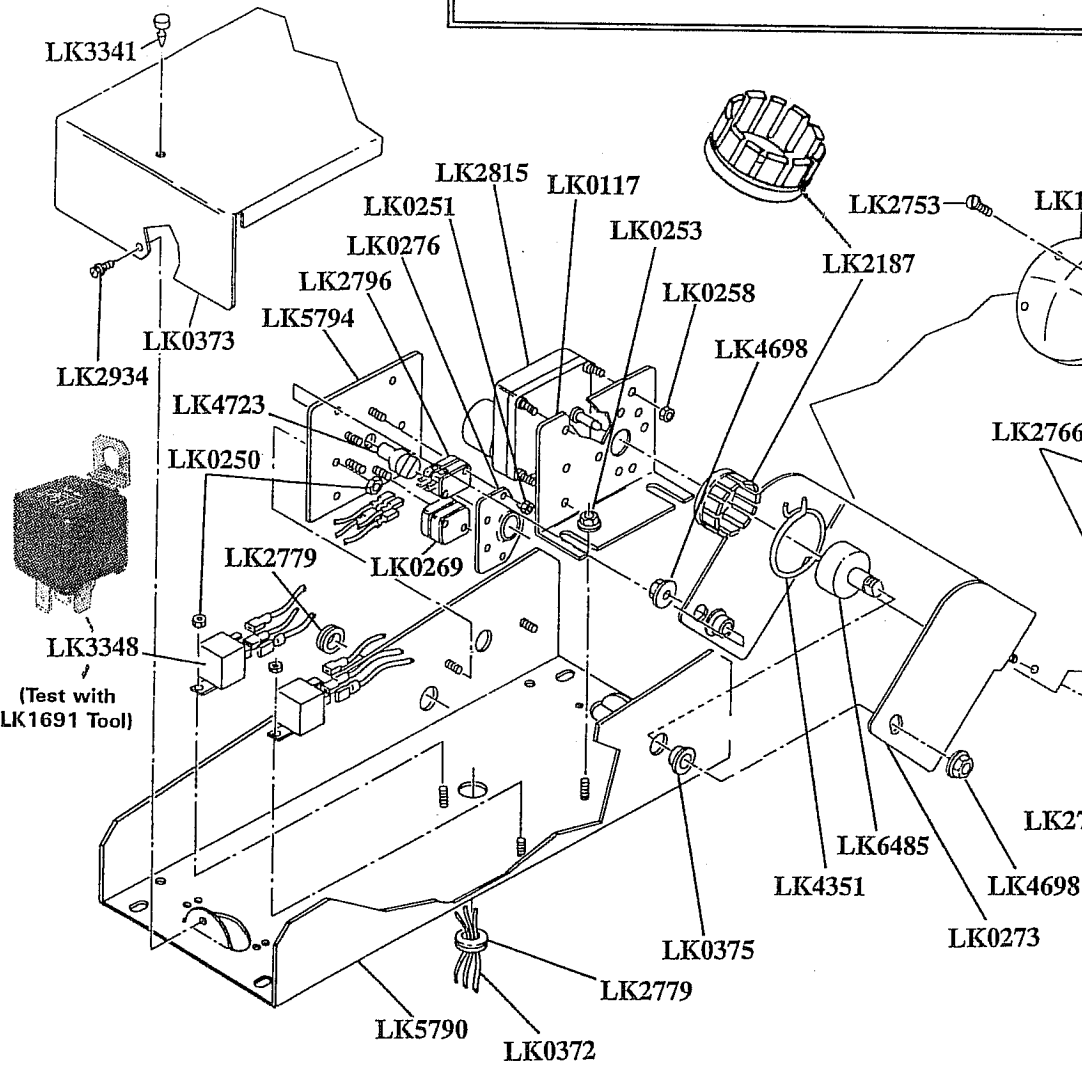
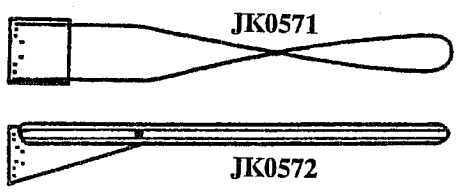
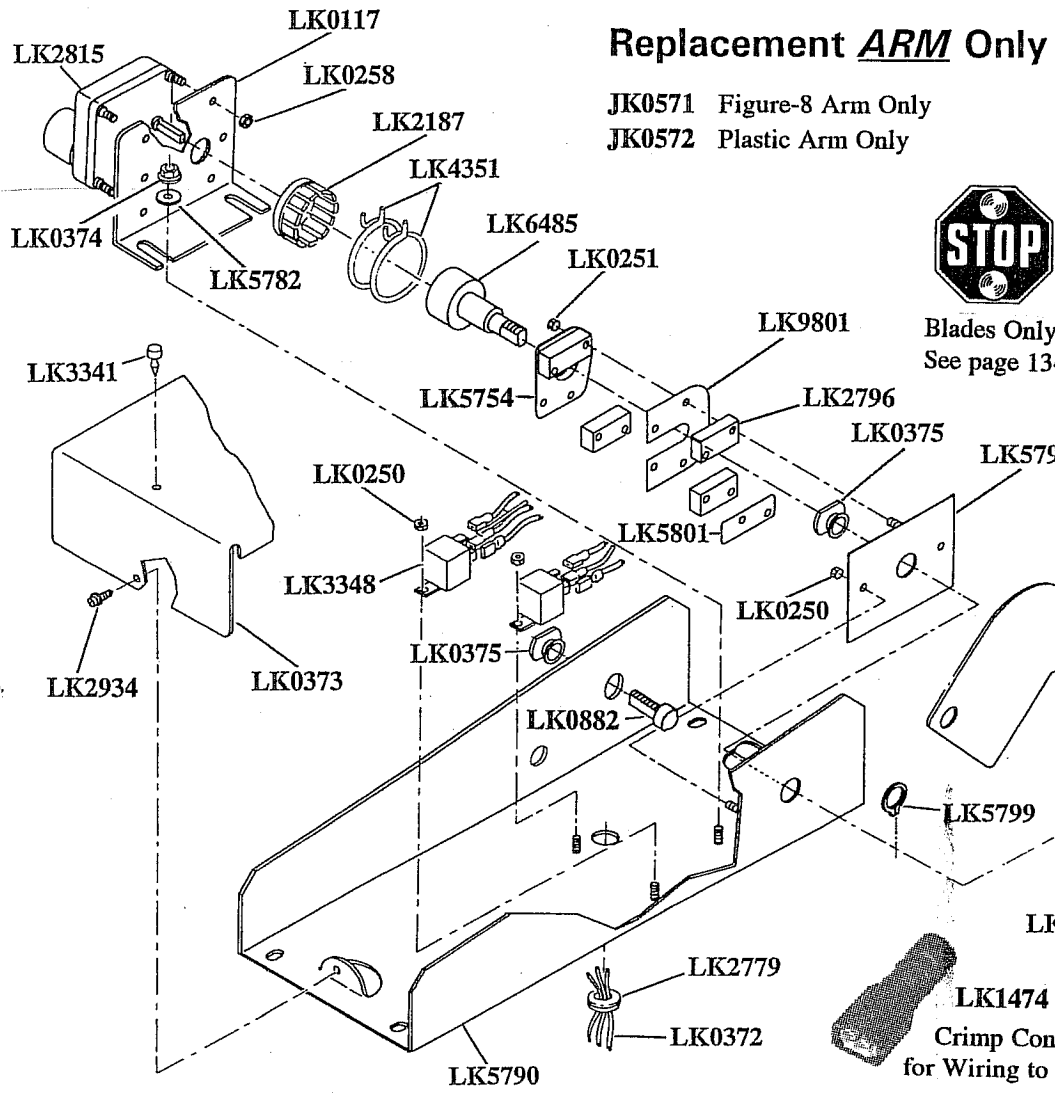

**Replacement ARM Only**

JK0571 Figure-8 Arm Only  
JK0572 Plastic Arm Only



1st Design	2nd Design
Parts For: Stop Arms 6/91 & Newer Crossing Arms 6/91-6/96	Parts For: Stop Arms 7-96-2/97 Crossing Arms 7/96 & Newer
<p>LK0375 LK6485 LK2187 LK2815 LK4723 LK0375 LK2796</p>	<p>LK0375 LK2796 LK6485 LK2187 LK2815 LK0882 LK0375</p>



- LK0945 How-to Attach Crossing Arms or Stop Arms to Any 8-Lamp Warning Lamp System
- LK2090 Troubleshoot Guide and Wiring Diagrams for 1st-Design Arms
- LK0675 Troubleshoot Guide and Wiring Diagrams for 2nd-Design Arms
- LK5755 How-to Convert 2nd-Design Crossing Arms from 3-Switches to the New 2-Switch Design