

**POWER STEERING GEARS**

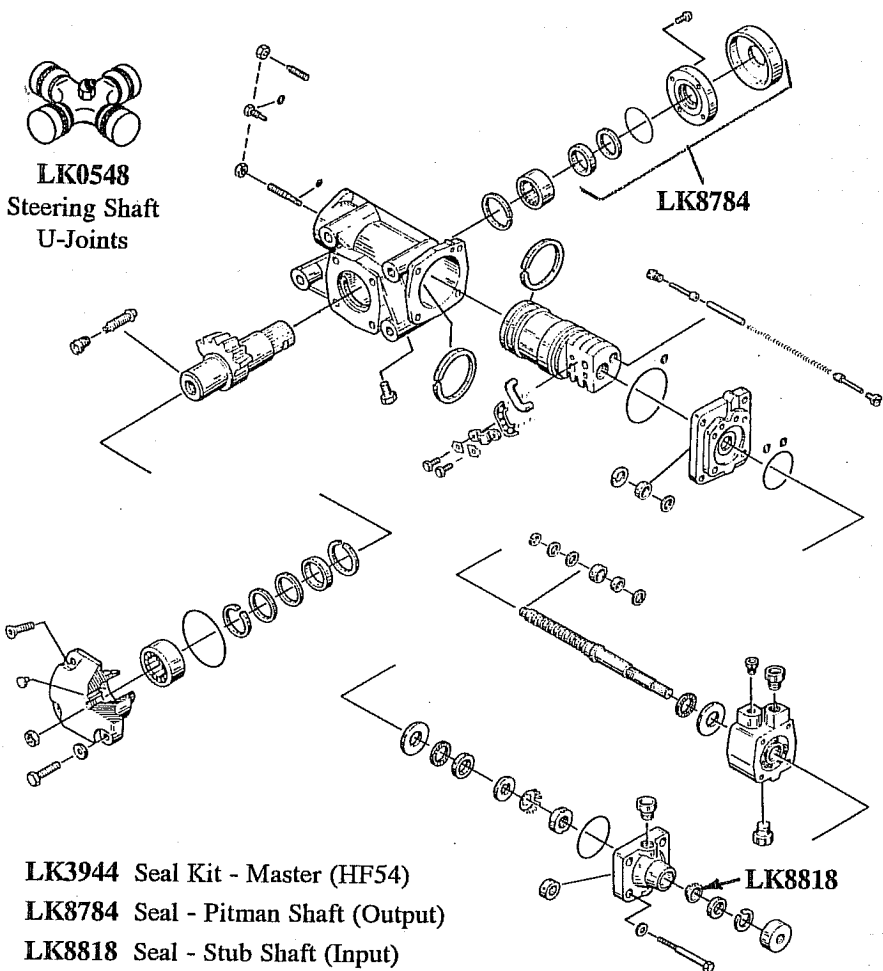

**TRW/Ross  
HF54**



- LK3944 Seal Kit - Master (HF54)
- LK8784 Seal - Pitman Shaft (Output)
- LK8818 Seal - Stub Shaft (Input)

**Steering Gears**

- LK3952 Reman HF54 Gear - For FORD - 1979 & Older  
Casting #HF542998 3-Bolt Mount
- LK3955 Reman HF54 Gear - For IHC - 1978 & Older  
Casting #HF542997 4-Bolt Mount
- LK3841 Reman HF54 Gear - For IHC - 1978 & Older  
Casting #HF542995 4-Bolt Mount
- JK0596 Steering Column Bearings - Ford
- JK0595 Steering Column Bearings - IH

**HOW TO IDENTIFY  
Ross Steering Gears**

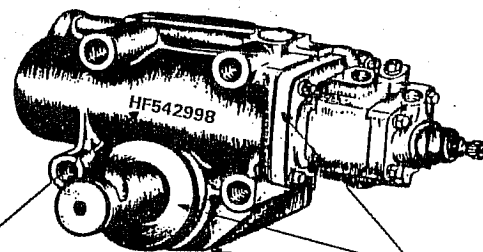

**RAISED** Casting Number  
Identifies **SERIES** Only,  
NOT Part Number.

**STAMPED** Numbers  
Identify Part.  
Numbers May Appear  
In Any of 3 Locations.

*If you are ordering a re-manufactured steering gear,  
please give us the following information:*

1. Year Model of Bus
2. Chassis Make (FORD or IHC)
3. Passenger Capacity (47/48, 59/60, etc.)
4. Front GAWR (Listed on Chassis Serial No. Plate)
5. Raised Casting Number (HF542996, etc.)
6. Stamped Part Number (HF54042, etc.)

**Steering Gears**

- LK0580 Reman Gear - For IH 1990 & Newer
- LK0572 New Gear - For IH
- LK0595 Reman Gear - For Blue Bird TC-2000
- LK0591 New Gear - For Blue Bird
- LK0600 Reman Gear - For Freightliner
- LK0597 New Gear - For Freightliner

- JK0595 Steering Column Bearings - IH
- JK0597 Steering Column Bearings - Blue Bird
- JK0598 Steering Column Bearings - Freightliner

**Ross  
TAS-40  
TAS-55  
TAS-65**

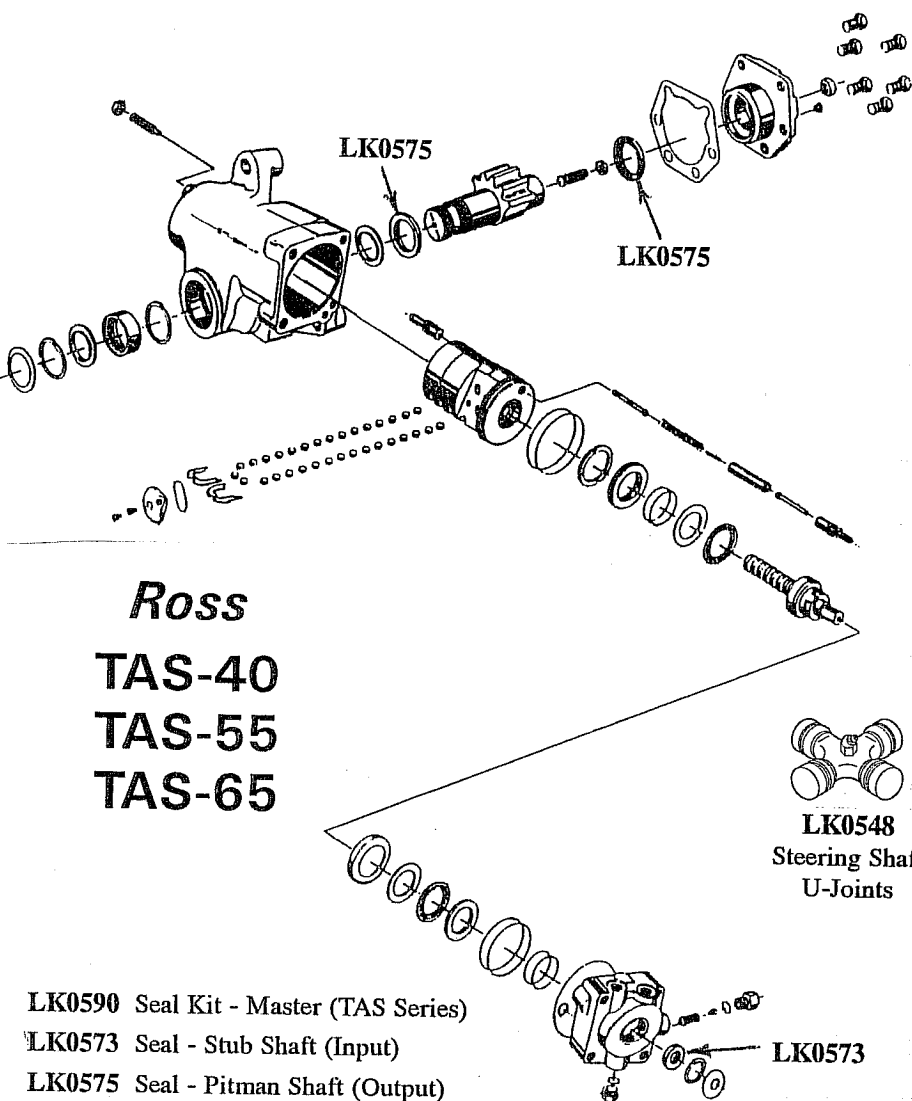

- LK0590 Seal Kit - Master (TAS Series)
- LK0573 Seal - Stub Shaft (Input)
- LK0575 Seal - Pitman Shaft (Output)

